



Materials

Mild Steel - Plain

A. Hot Rolled Steel Plates, Sheets and Coils **S235 JR**, as per:

EN 10025 -2 / DIN 17100 / BS 4360 / ASTM A 653M / ASTM A 1011 / ASTM A 1011-01a
 JIS 3101 / JIS 3106 / GB 700 / GB / T1591.

ASTM A 907 / ASTM A 1018M.

ASTM A 570M / ASTM A 572M.

B. Cold Rolled Steel **DC 01**, as per:

EN 10130 / DIN 1623, Part 2 / BS 1449:1 / ASTM A366 / ASTM A 1008 / JIS G 3141 / GB 699.

EN 10131 / ASTM A 568M

Mild Steel - Galvanized

C. Continuously Pre- Galvanized Hot-Dip Zinc Coated Steel **DX 51D + Z**, as per:

EN 10327 / DIN 17162 / BS 2989/ ASTM A 527M / ASTM A 653M / JIS G 3302.

EN 10326/ EN 10142 / ASTM A 526, 527, 528/ ASTM A 146

D. Electro Galvanized Steel (Electrolytic Coating) **DC01 + ZE v**, as per:

EN 10152 / DIN 17163 / ASTM A591 / JIS G 3313 / JIS G 3141/BS 1449:1

EN 10131

Aluminum

E. Aluminum **6063 T6**

Stainless Steel

F. Austenitic Stainless Steels **SS 304 & SS 316**, as per:

ASTM A 240 / EN 10088-2/ DIN 17400 / BS 1449:2 / ASTM A480 / ASTM A666 / ISO 3506 / EN 10028-7 / JIS G 4304

F1 Stainless Steel Fasteners EN 3506

F2 Stainless Steel Wire BS 1554 ,ASTM A276

Finishes

1- Hot-DIP Galvanization after Fabrication

as per:

ASTM A 123 / ASTM A 153 / ISO 1461.

BS 729 / DIN 50976

2- Zinc Electroplating after Fabrication

as per:

ASTM B633 / EN 12329 / ISO 4042/ BS 1706 / BS 3382 / DIN 50961

3- Powder Coating

Epoxy / Polyester / Epoxy & Polyester

BS 3900 / ISO 2409 / ISO 1519 / ISO 1520





Channel

SFSP's metal framing channel is cold formed on modern rolling machines from low carbon steel manufactured according to BS 6946:1988. A continuous slot provides the ability to make attachments at any point.

Lengths

Standard length: 3000mm with ± 3.2mm length tolerance.
Custom lengths available upon request.

Finishes

Standard Finishes: Pre-Galvanized finish (ASTM A653M coating G90 and G60). Hot Dip Galvanized after fabrication (ASTM A123 or BS EN ISO1461:2009). Other custom coatings are available upon request.

Metal Framing Channels

Selection Chart

Part No	Channel Dimensions		Thickness
	Height "H"	Width "W"	
CCH - 220/221	21.0 mm	41.0 mm	1.5 mm
CCH - 240/241	41.0 mm	41.0 mm	1.5 mm
CCH - 260/261	25.0 mm	50.0 mm	1.5 mm
CCH - 320/321	21.0 mm	41.0 mm	2.0 mm
CCH - 340/341	41.0 mm	41.0 mm	2.0 mm
CCH - 360/361	25.0 mm	50.0 mm	2.0 mm
CCH - 420/421	21.0 mm	41.0 mm	2.5 mm
CCH - 440/441	41.0 mm	41.0 mm	2.5 mm
CCH - 460/461	25.0 mm	50.0 mm	2.5 mm

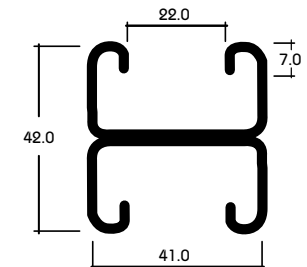
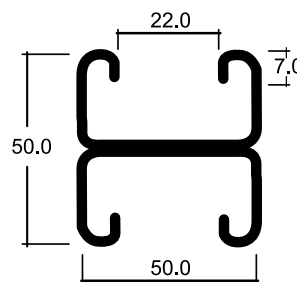
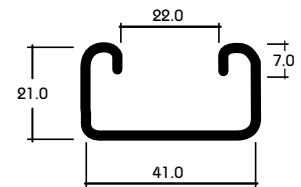
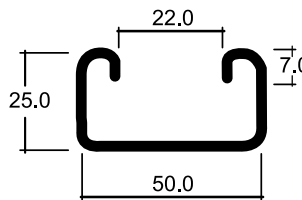

For Toothed Channel add "T" after the Part no. ex: CCH-220T

CCH 320

3 Material Thickness
2 for 1.5 mm
3 for 2.0 mm
4 for 2.5 mm

2 Size
2 - 21/41 mm
4 - 41/41 mm
6 - 25/50 mm

0 Channel Patterns
0 - PT
1 - ST
2 - B2B

T Toothed channel

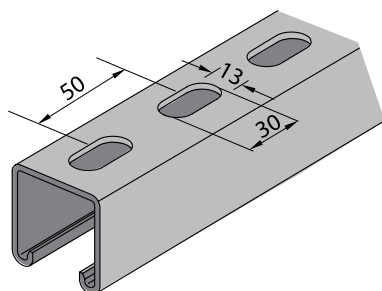
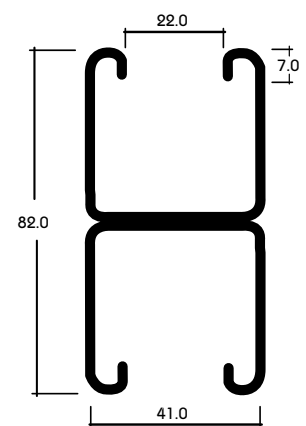
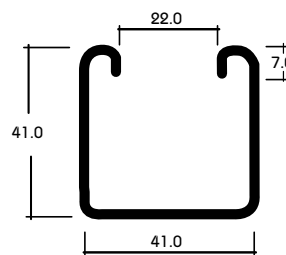



Channel Hole Patterns

PT Type Channel



ST Type Channel



B2B Type Channel



Part No	Thick. mm.	Height "H"
CCH-220	1.5	21.0
CCH-240	1.5	41.0
CCH-260	1.5	25.0
CCH-320	2.0	21.0
CCH-340	2.0	41.0
CCH-360	2.0	25.0
CCH-420	2.5	21.0
CCH-440	2.5	41.0
CCH-460	2.5	25.0

Part No	Thick. mm.	Height "H"
CCH-221	1.5	21.0
CCH-241	1.5	41.0
CCH-261	1.5	25.0
CCH-321	2.0	21.0
CCH-341	2.0	41.0
CCH-361	2.0	25.0
CCH-421	2.5	21.0
CCH-441	2.5	41.0
CCH-461	2.5	25.0

Part No	Thick. mm.	Height "H"
CCH-222	1.5	42.0
CCH-242	1.5	82.0
CCH-262	1.5	50.0
CCH-322	2.0	42.0
CCH-342	2.0	82.0
CCH-362	2.0	50.0
CCH-422	2.5	42.0
CCH-442	2.5	82.0
CCH-462	2.5	50.0

Toothed channel type

For Toothed Channel add "T" after the Part no. ex: CCH-220T





Cantilever Arm Bracket

Cantilever Arm Brackets - SCA

CCH421 41x21x2.5

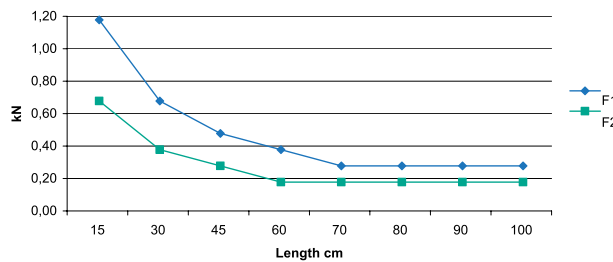
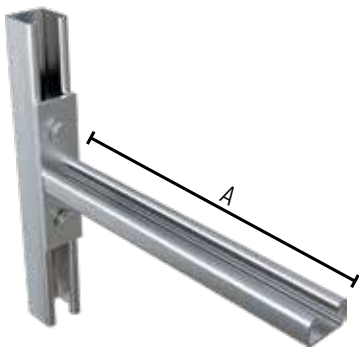

Length (A (mm))	Allowable Load		
	*F ₁	*F ₂	**F ₂
150	1.10	0.60	3.10
300	0.60	0.30	3.10
450	0.40	0.20	3.10
600	0.30	0.10	3.10
700	0.20	0.10	3.10
800	0.20	0.10	3.10
900	0.20	0.10	3.10
1000	0.20	0.10	3.10

Base plate : height (h) x width (b) x thickness (t)
100 50 8

-In the case of concrete support frame, use anchor M10
-In the case of concrete C-Channel frame, Hex bolt M8.
** Connection force (pull-out force) : 3.10 (kN)

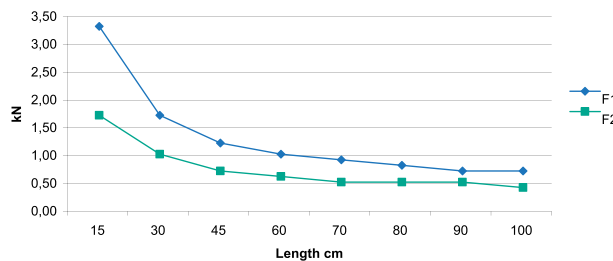
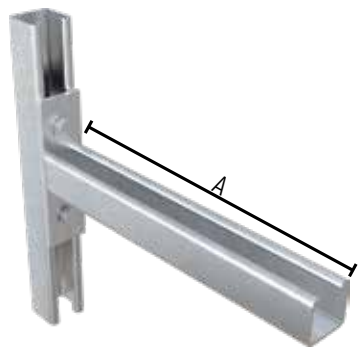

Length (A (mm))	Allowable Load		
	*F ₁	*F ₂	**F ₂
150	3.10	1.50	7.50
300	1.50	0.80	7.50
450	1.00	0.50	7.50
600	0.80	0.40	7.50
700	0.70	0.30	7.50
800	0.60	0.30	7.50
900	0.50	0.30	7.50
1000	0.50	0.20	7.50

Base plate : height (h) x width (b) x thickness (t)
140 50 10

-In the case of concrete support frame, use anchor M16 .
-In the case of concrete C-Channel frame, Hex bolt M8.
** Connection force (pull-out force) : 7.50 (kN)

* Given Loads are always in [kN] " Allowable characteristic live load "

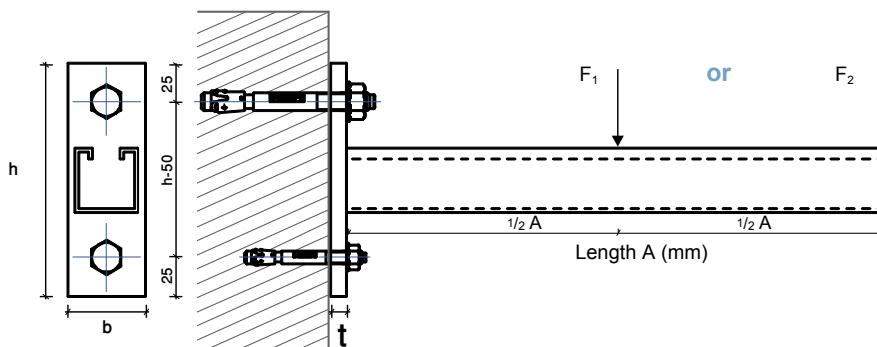



Cantilever Arm Bracket

Cantilever Arm Brackets - SCA

CCH422 41x21x2.5 B2B

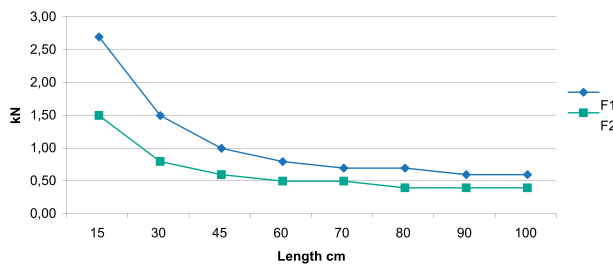
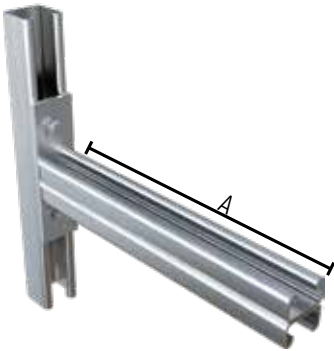

Length (A (mm))	Allowable Load		
	*F ₁	*F ₂	**F ₂
150	2.50	1.30	4.80
300	1.30	0.60	4.80
450	0.80	0.40	4.80
600	0.60	0.30	4.80
700	0.50	0.30	4.80
800	0.50	0.20	4.80
900	0.40	0.20	4.80
1000	0.40	0.20	4.80

Base plate : height (h) x width (b) x thickness (t)
140 50 10

-In the case of concrete support frame, use anchor M12.
-In the case of concrete C-Channel frame, Hexbolt M8.

CCH442 41x41x2.5 B2B

** Connection force (pull-out force) : 4,8 (kN)

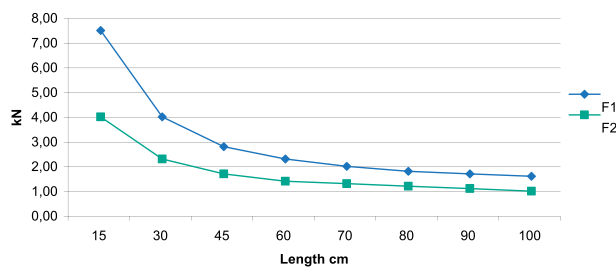
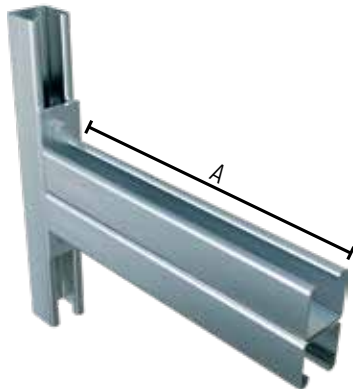

Length (A (mm))	Allowable Load		
	*F ₁	*F ₂	**F ₂
150	7.00	3.50	8.30
300	3.50	1.80	8.30
450	2.30	1.20	8.30
600	1.80	0.90	8.30
700	1.50	0.80	8.30
800	1.30	0.70	8.30
900	1.20	0.60	8.30
1000	1.10	0.50	8.30

Base plate : height (h) x width (b) x thickness (t)
180 60 12

-In the case of concrete support frame, use anchor M16.
-In the case of concrete C-Channel frame, Hex bolt M10 .

** Connection force (pull-out force) : 8,30 (kN)

* Given Loads are always in [kN] * Allowable characteristic live load "

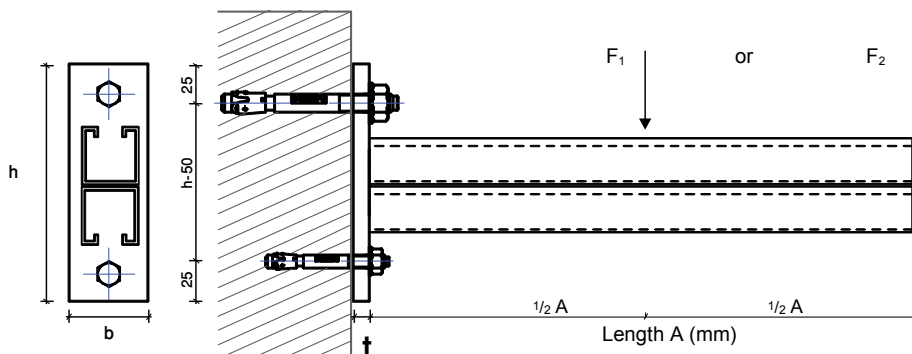



U - Support / 3000

3000

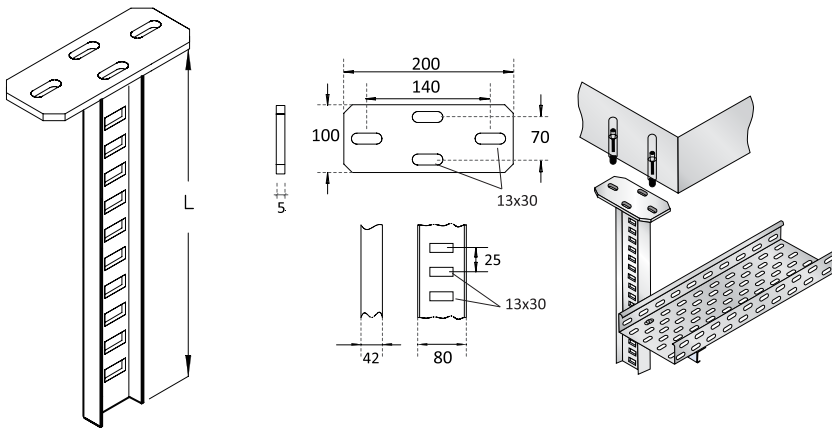

U-Support with welded-on head plate 200 x 100 x 5mm

I - Support / 3050

3050

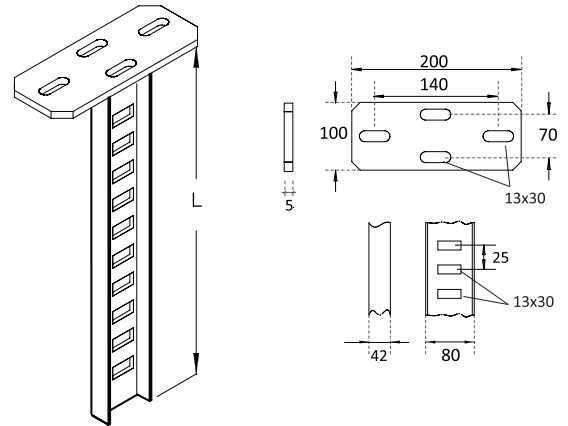

U-Support with welded-on head plate 200 x 100 x 5mm

Head Plate / 3100

3100

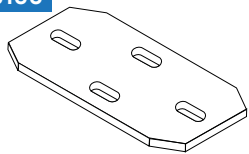

200 x 100 x 5mm

Wall Bracket | 3200 - 3250

3200

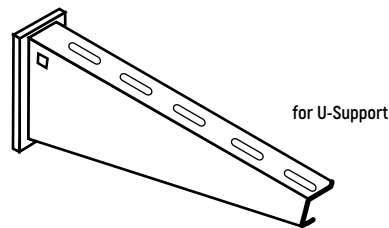

5 mm thickness

3250

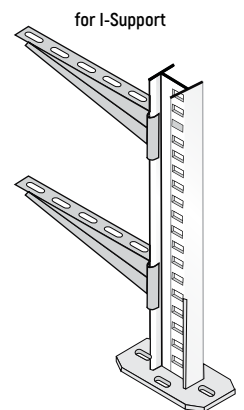



Support connectors | 3300

3300

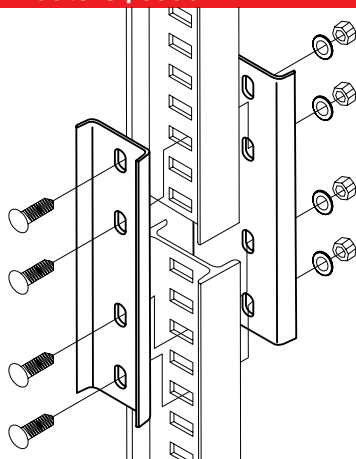

Clamping plates | 3350

3350

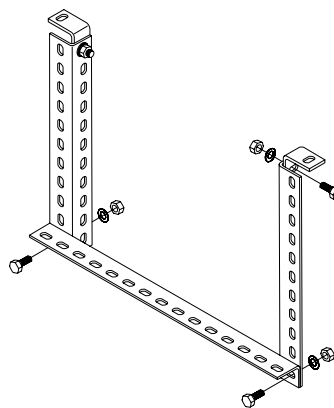

Support plates | 3400

3400

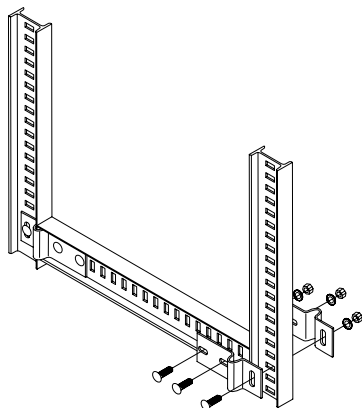

Support clamps | 3450

3450

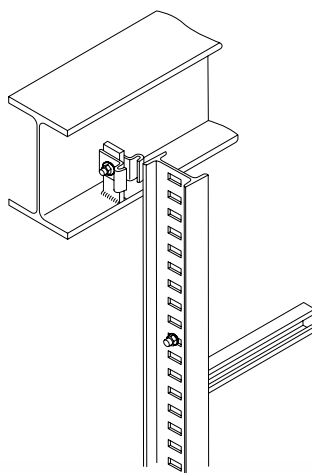

Clamping angles | 3550

3550

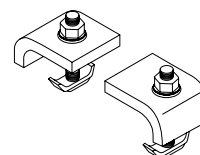

Angles | 3600

3600

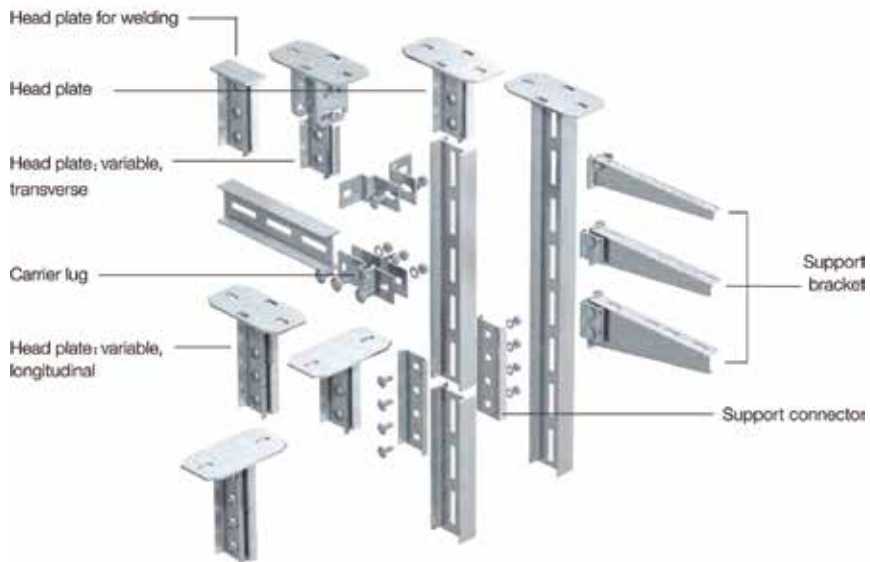



Framing Systems

Fully Threaded Rods Grade 4.6 DIN 975 ASTM A 36, A193

Threaded Rod (STR) - DIN 975 - ASTM A36

Zinc Plated Thread	Length	Load cap
	(mm)	(kN)
M6	2000/3000	2.2
M8	2000/3000	4.0
M10	2000/3000	6.4
M12	2000/3000	12.9
M16	2000/3000	17.3
M18	2000	22.0
M20	2000	27.0



Square Washers SSW

Square Washers (SSW)

H.D. Galvanized Bolt	Stainless Steel Bolt	a x b x d
		(mm)
M8	M10	(x 40 x (4-5-6 40
M10	M12	(x 40 x (4-5-6 40
M12	M16	(x 40 x (4-5-6 40



ASTM F436

Washers (SRW) | DIN 125 | ASTM F436

Zinc Plated	Stainless Steel	D	d	S
		(mm)	(mm)	(mm)
M6	M6	12	6.4	1.6
M8	M8	16	8.4	1.6
M10	M10	21	10.5	2
M12	M12	24	13	2.5
M16	M16	30	17	3
M18	M18	34	19	3.2
M20	M20	39	20.5	3.6

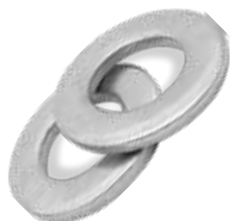

Round Washers DIN 440, DIN 9021

Washers (SRW) | DIN 440 | DIN 9021

DIN	Zinc Plated	Stainless Steel	D	d	S
			(mm)	(mm)	(mm)
440	M6		22	6.6	2
9021	M8	M8	24	8.4	2
9021	M10	M10	30	10.5	2.5
440	M12		45	13.5	4
9021	M12	M12	37	13	3
9021	M16	M16	50	17	3

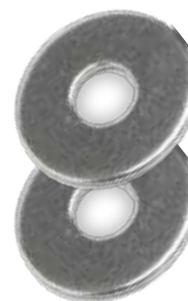

Hexagon Nuts DIN 934, DIN EN 24032

Hexagon nut (SHN) | DIN 934 or ISO 4032
(= DIN EN 24032)

Zinc Plated Thread	S/m DIN	S/m ISO	e
	(mm)	(mm)	(mm)
M6	10/5	10/6	11.5
M8	13/6.5	13/7.5	15.0
M10	17/8	16/9.5	19.6
M12	19/10	18/12	21.9
M16	24/13	24/15.5	27.7



Square Washers SSW

Square Washers (SSW)

H.D. Galvanized Bolt	Stainless Steel Bolt	a x b x d
		(mm)
M8	M10	(x 40 x (4-5-6 40
M10	M12	(x 40 x (4-5-6 40
M12	M16	(x 40 x (4-5-6 40





Machine HexHead Bolts DIN 933, DIN 24017

Zinc Plated Dimension	S DIN	S EN
	(mm)	(mm)
M 6 x 12	10	10
M 6 x 25		
M 8 x 25	13	13
M 8 x 40		
M 10 x 20	17	16
M 10 x 30		
M 10 x 45		
M 10 x 60		
M 10 x 70		
M 12 x 22		
M 12 x 25	19	18
M 12 x 30		
M 12 x 40		
M 12 x 50		
M 12 x 60		
M 12 x 80		
M 12 x 90		
M 16 x 40	24	24
M 16 x 60		
M 16 x 90		

Hex Head Bolt (SHB)
DIN 933 or EN 24017 (without nut)

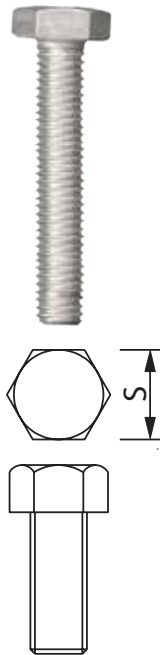

Coupler Sleeves Rounded

Electroplated Thread	D (mm)	L (mm)	Load cap (KN)
M6	10/10	15	2.2
M8	12/14	20	4.0
M10	13/16	25	6.4
M12	16/20	30	9.3
M16	21/25	40	17.3
M20	26/32	50	27.0

Coupler Sleeves (SCS)

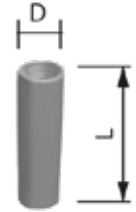

Hexagonal Rod Coupler

Electroplated Thread	D (mm)	L (mm)	Load cap (KN)
M10	13	40	6.4
M12	17	40	9.3
M16	22	50	17.3

Hexagonal Rod Coupler with view hole (SHR)

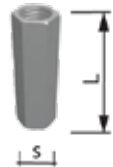

Hexagonal Rod Coupler with view hole

Size	G	F		H	
	Min.	Min.	Max.	Min.	Max.
M6	11.05	9.78	10	17.6	18
M8	14.38	12.73	13	23.5	24
M10	18.9	16.73	17	29.5	30
M12	21.1	18.67	19	35.4	36
M16	26.75	23.67	24	47.0	48
M20	32.95	29.16	30	58.1	60
M24	39.55	35.00	36	70.1	72
M30	50.85	45.00	46	87.8	90

Hexagonal Rod Coupler with view hole (SHR)

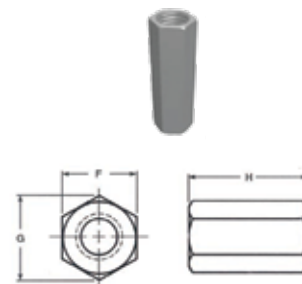

Finishing Available : Electroplated, HDG, SS AISI 304 & 316

Specification Requirements:

Dimensions: H, F and G - as above

Threads type: 6H

Mechanical Properties: class 6. Proof Load Strength 600MPa

Finish: Electro-plated

Remarks:

- Above Coupling Nut to be used with Threaded Rod Class 4.6 or less
- Threaded Rod to be extended inside the Coupler with distance equal or greater than the nominal Threaded diameter which is equal to H/2



Fittings

Square Washer

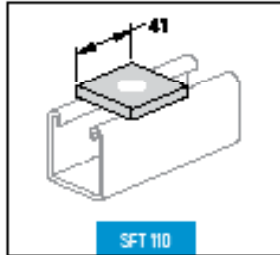

Splice Plate

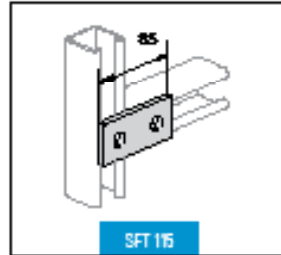

Splice Plate

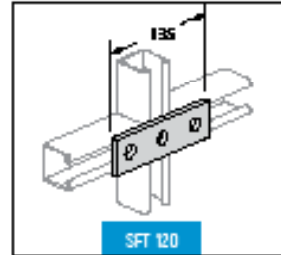

Splice Plate

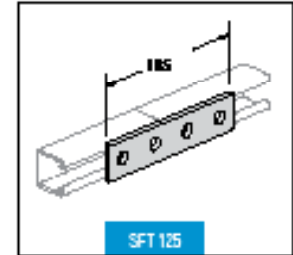

Splice Plate

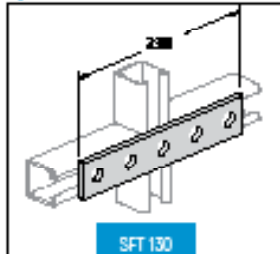

Splice Plate

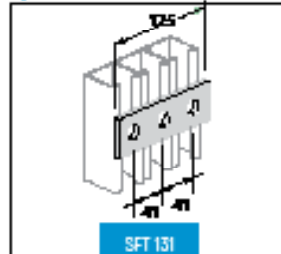

Square Splice Plate

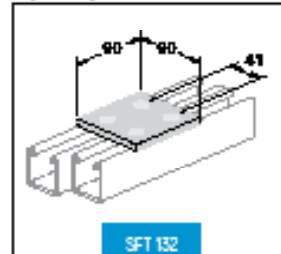

Angle Plate

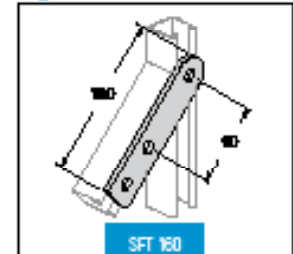

Angle Plate

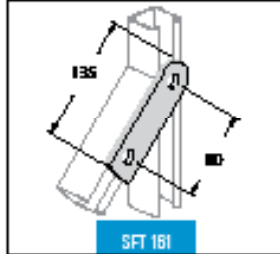

L-Plate

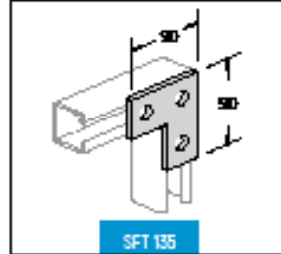

L-Plate

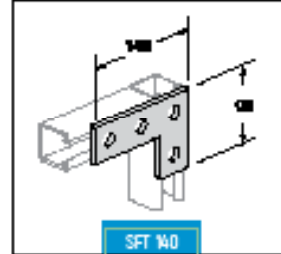

T-Plate

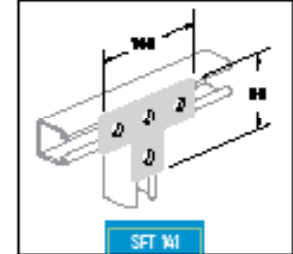

Plus Plate

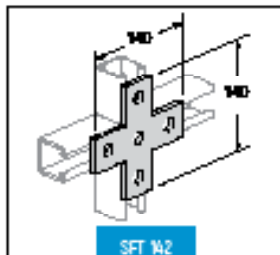

T-Plate

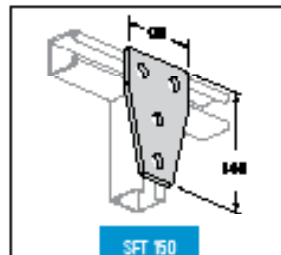

T-Plate

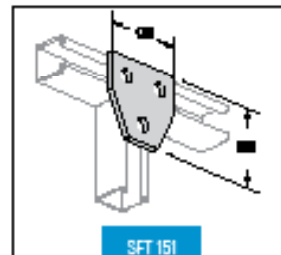

T-Plate

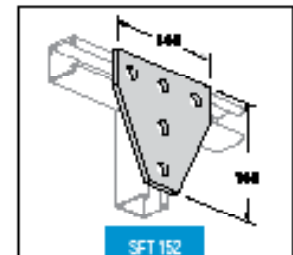

T-Plate

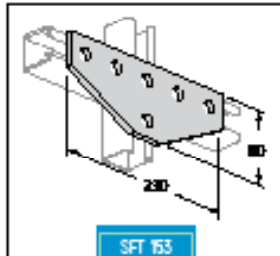

Plus Plate

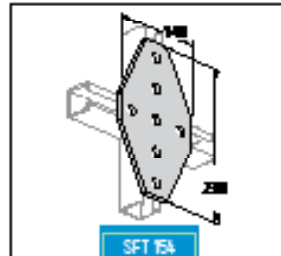

45° Plate

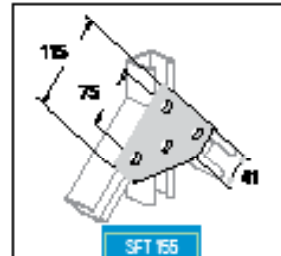

90° Plate

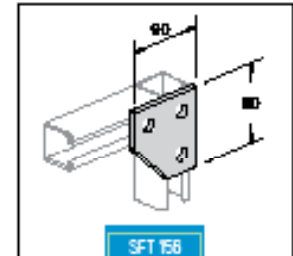



90° Plate

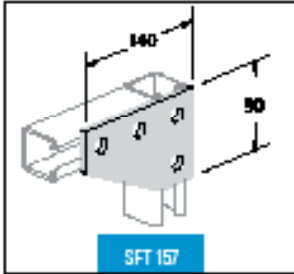

SFT 157

90° Plate

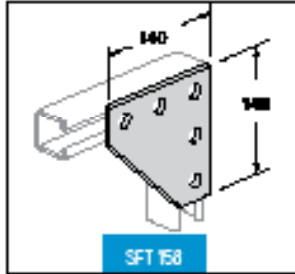

SFT 158

L-Bracket

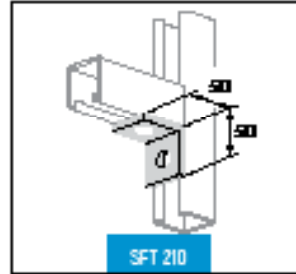

SFT 210

L-Bracket

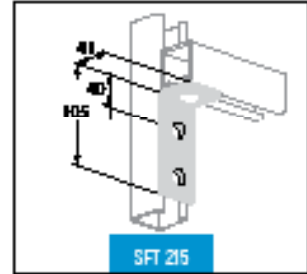

SFT 215

L-Bracket

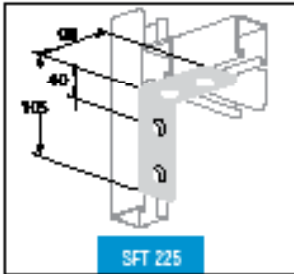

SFT 225

L-Bracket

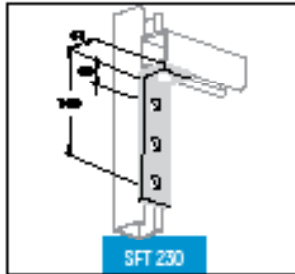

SFT 230

L-Plate

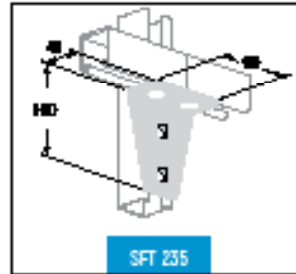

SFT 235

L-Plate

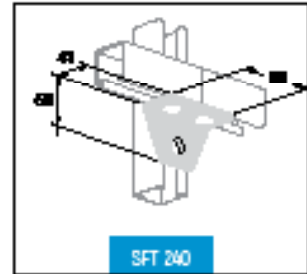

SFT 240

Angle Plate

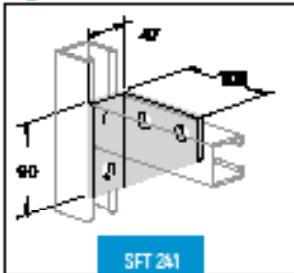

SFT 241

Angle Plate

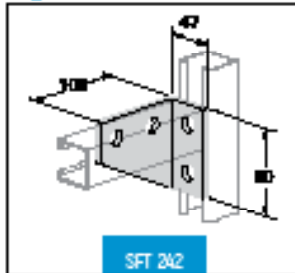

SFT 242

Angle Plate

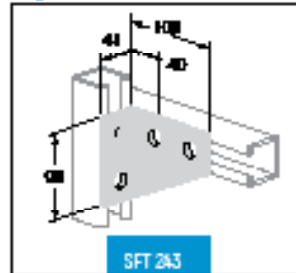

SFT 243

Angle Plate

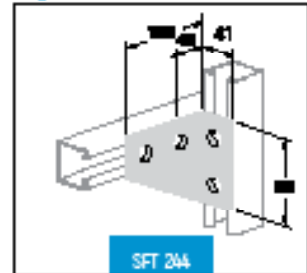

SFT 244

Angle Plate

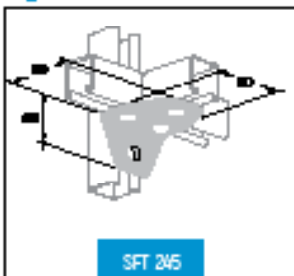

SFT 245

Angle Plate

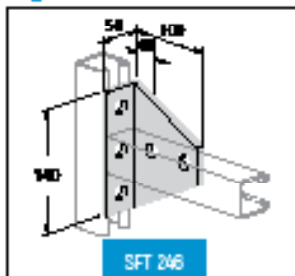

SFT 246

Angle Plate

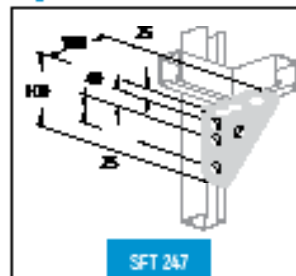

SFT 247

Angle Plate

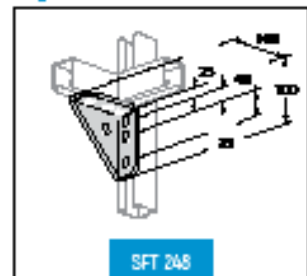

SFT 248

Angle Plate

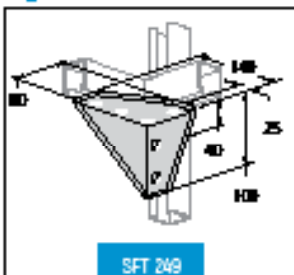

SFT 249

Angle Plate

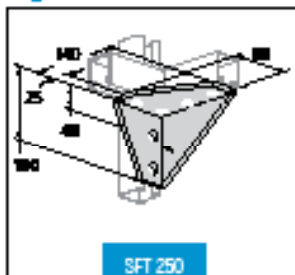

SFT 250

Angular Bracket



SFT 510

Angular Bracket



SFT 511



Angular Bracket

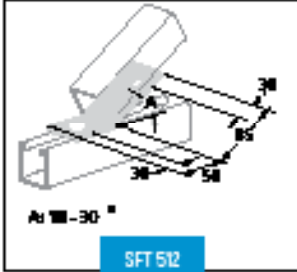

SFT 512

Angular Bracket

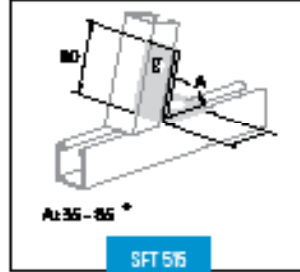

SFT 515

T-Corner Left

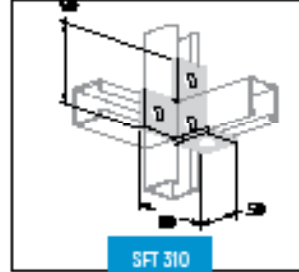

SFT 310

T-Corner Right

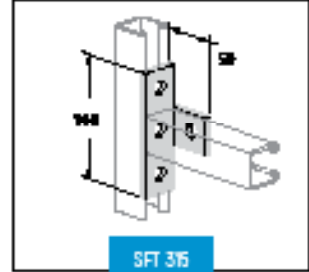

SFT 315

T-Center

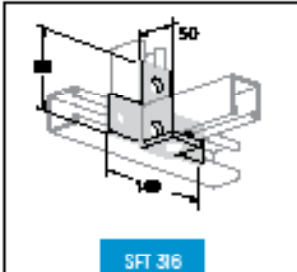

SFT 316

T-Corner Right

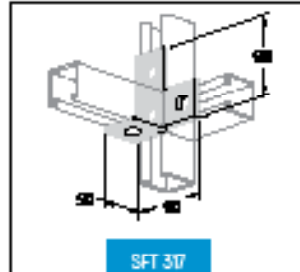

SFT 317

Double Wing Joint



SFT 320

Double Wing Joint

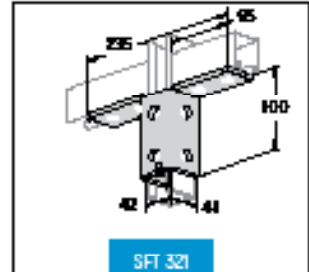

SFT 321

Double Wing Joint

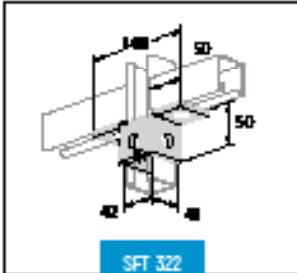

SFT 322

U & Wing Bracket

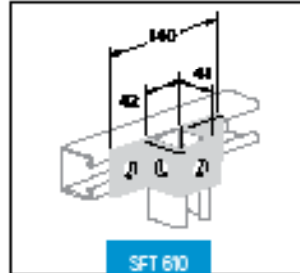

SFT 610

U & Wing Bracket

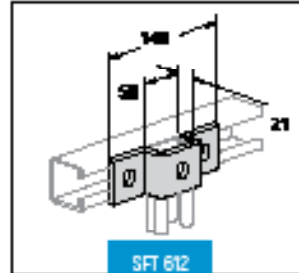

SFT 612

U & Wing Bracket

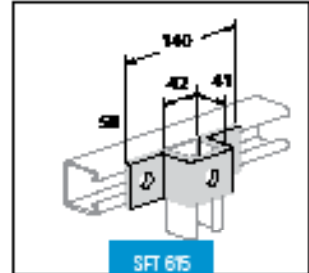

SFT 615

U & Wing Bracket

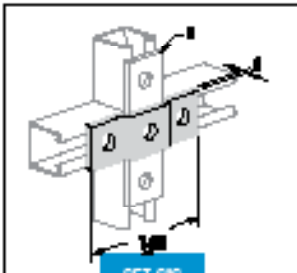

SFT 616

U & Wing Bracket

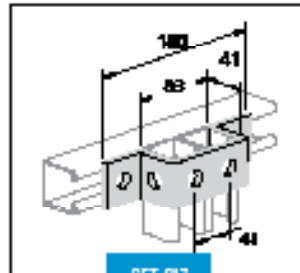

SFT 617

U & Wing Bracket

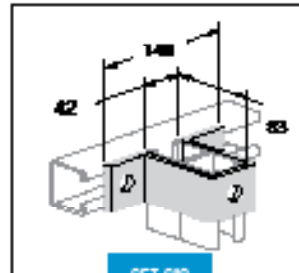

SFT 618

U & Wing Bracket

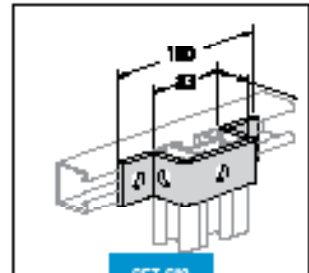

SFT 619

U & Wing Bracket

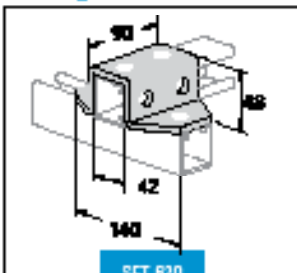

SFT 620

U & Wing Bracket

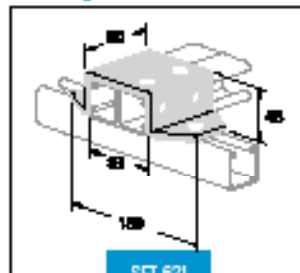

SFT 621

Single Channel Gussated Bracket

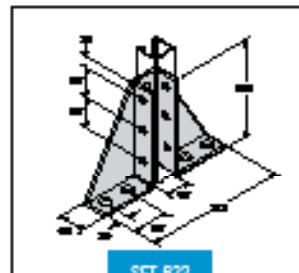

SFT 622

Double Channel Gussated Bracket

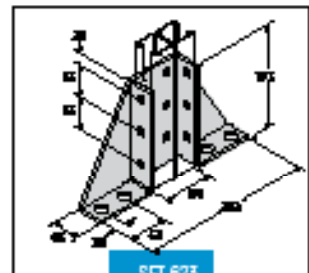

SFT 623



Beam Clamp

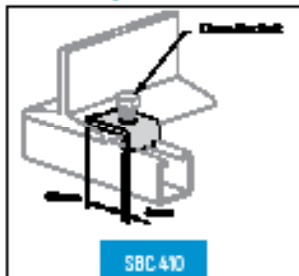

SBC 410

Beam Clamp

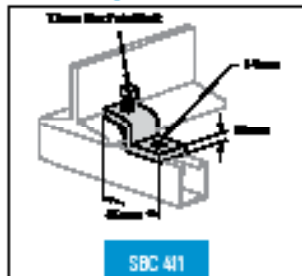

SBC 411

Beam Clamp

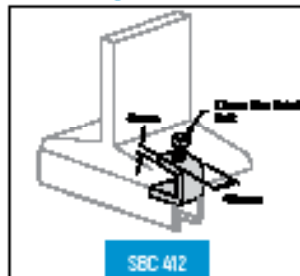

SBC 412

Beam Clamp

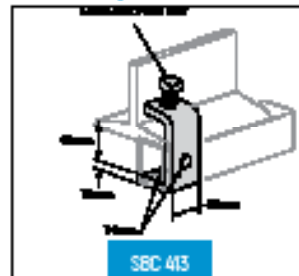

SBC 413

Beam Clamp

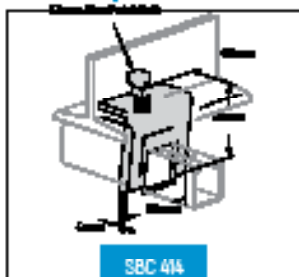

SBC 414

Beam Clamp

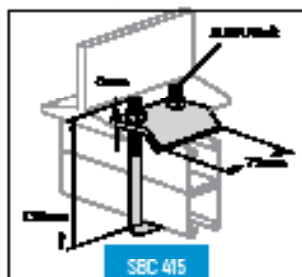

SBC 415

Beam Clamp

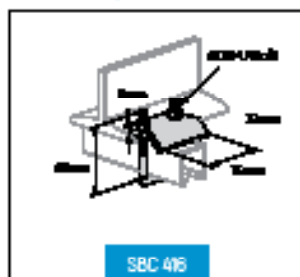

SBC 416

Beam Clamp

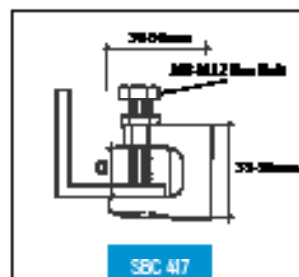

SBC 417

U - Joint Bracket

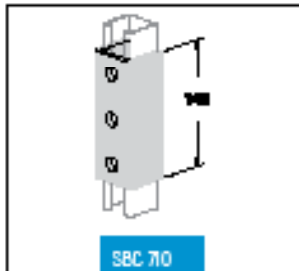

SBC 70

U - Joint Bracket

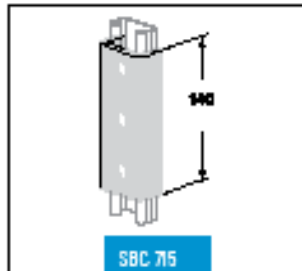

SBC 75

U - Joint Bracket

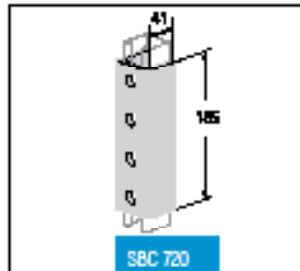

SBC 720

Plastic End Caps For Channels



NSP910

NSP911



Post Base

Base Plate with Single Fix

SFT 340

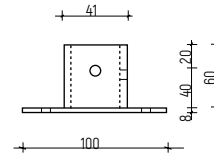
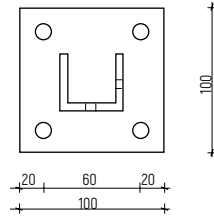
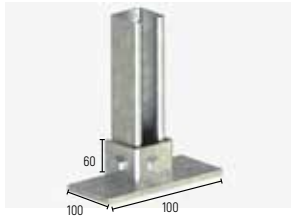

Base Plate with Double Fix

SFT 345

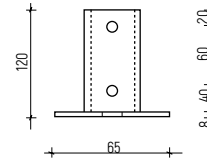
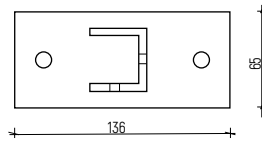
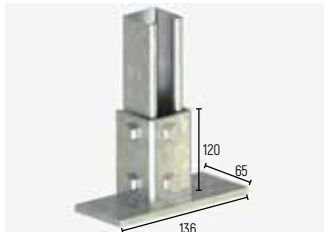

Base Plate with Double Fix

SFT 346

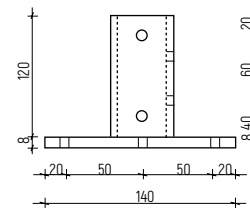
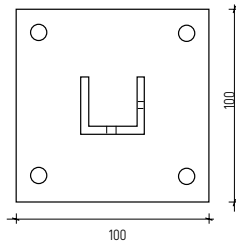
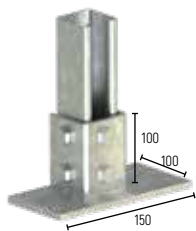

Base Plate with Double Channel

SFT 350

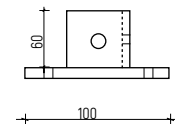
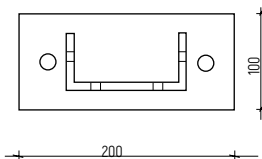
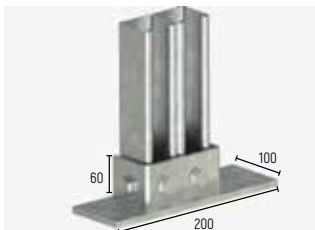

Base Plate with Double Channel Double Fix

SFT 355

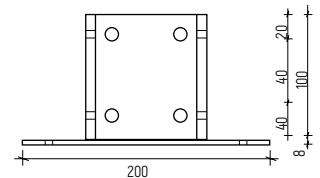
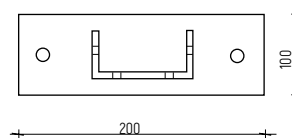
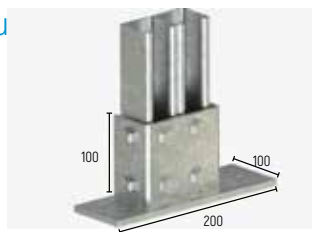

Base Plate with Double Channel Double Fix

SFT 356

